

# Enviroboards

**Fire-Board**

**Uni-Board**

## Enviroboards 12mm Fireboard Installation

### Cutting Enviroboards 12mm:

Enviroboards 12mm can be cut with a handsaw (Medium/Fine), or Skilsaw/circular saw

### Fixing instruction:

Fix board to stud with 4mm diameter x 60mm screws, at 300mm centres approximately 10mm from the board edge

### Jointing:

Boards to be installed with a joint gap of 3mm (-1mm/+2mm). All joints to be sealed with intumescent sealant

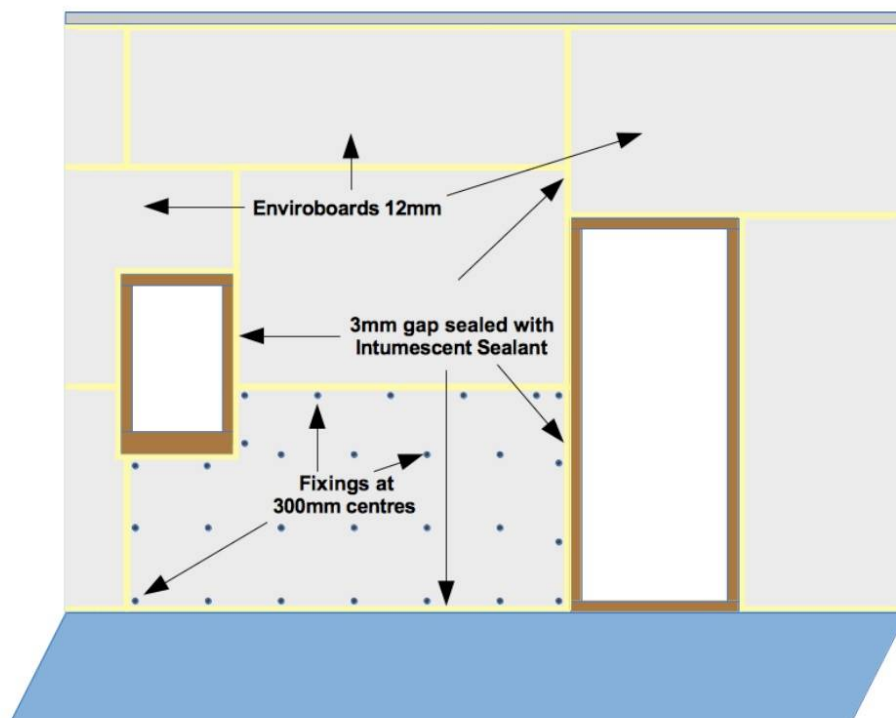

To match Enviroboards BS476 Part 22 classification, Enviroboards 9mm should be installed on both faces of the partition wall and incorporate slabs of 50mm Rockwool insulation. Please contact Enviroboards for the full test report.

**Enviroboards are classified as a non-dangerous substance. Please refer to the Enviroboards Material and Chemical Safety DATA Sheet for more information**

[www.enviroboards.co.uk](http://www.enviroboards.co.uk)  
VAT Registration No: 101 1279 73

Tel: 08455 208880

[info@enviroboards.co.uk](mailto:info@enviroboards.co.uk)  
Company Registration No: 7365331