

Enviroboards

Fire-Board

Uni-Board

Enviroboards 9mm Fireboard Installation

Cutting Enviroboards 9mm:

Enviroboards 9mm can be cut with a handsaw (Medium/Fine), or Skilsaw/circular saw

Fixing instruction:

Fix board to stud with 4mm diameter x 60mm screws, at 300mm centres approximately 10mm from the board edge

Jointing:

Boards to be installed with a joint gap of 3mm (-1mm/+2mm). All joints to be sealed with intumescent sealant

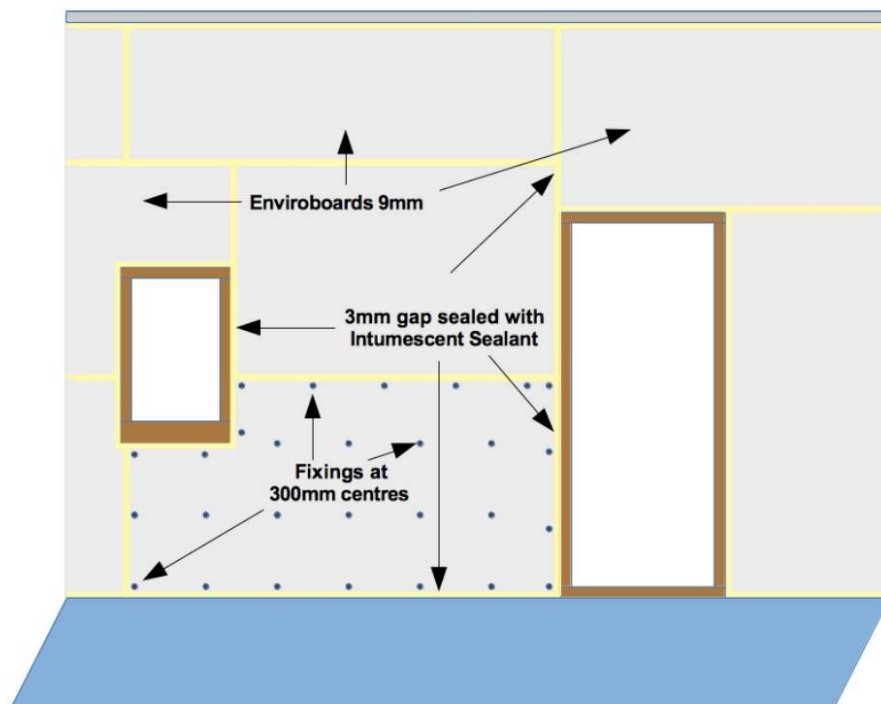

To match Enviroboards BS476 Part 22 classification, Enviroboards 9mm should be installed on both faces of the partition wall and incorporate slabs of 100mm Rockwool insulation. Please contact Enviroboards for the full test report.

Enviroboards are classified as a non-dangerous substance. Please refer to the Enviroboards Material and Chemical Safety DATA Sheet for more information